

Dimensions are not to be scaled from this drawing or from CAD files.
 This drawing is based on currently available information and is not to be used as an accurate measurement of area.
 All dimensions must be checked on site before any work is commenced and any discrepancies are to be immediately notified to the Contract Administrator for direction.
 This drawing is the property of Southend-on-Sea Borough Council and therefore Copyright is reserved by them. The drawing is issued on condition that it is not copied or disclosed by or to any unauthorised persons without the prior consent in writing of Southend-on-Sea Borough Council.

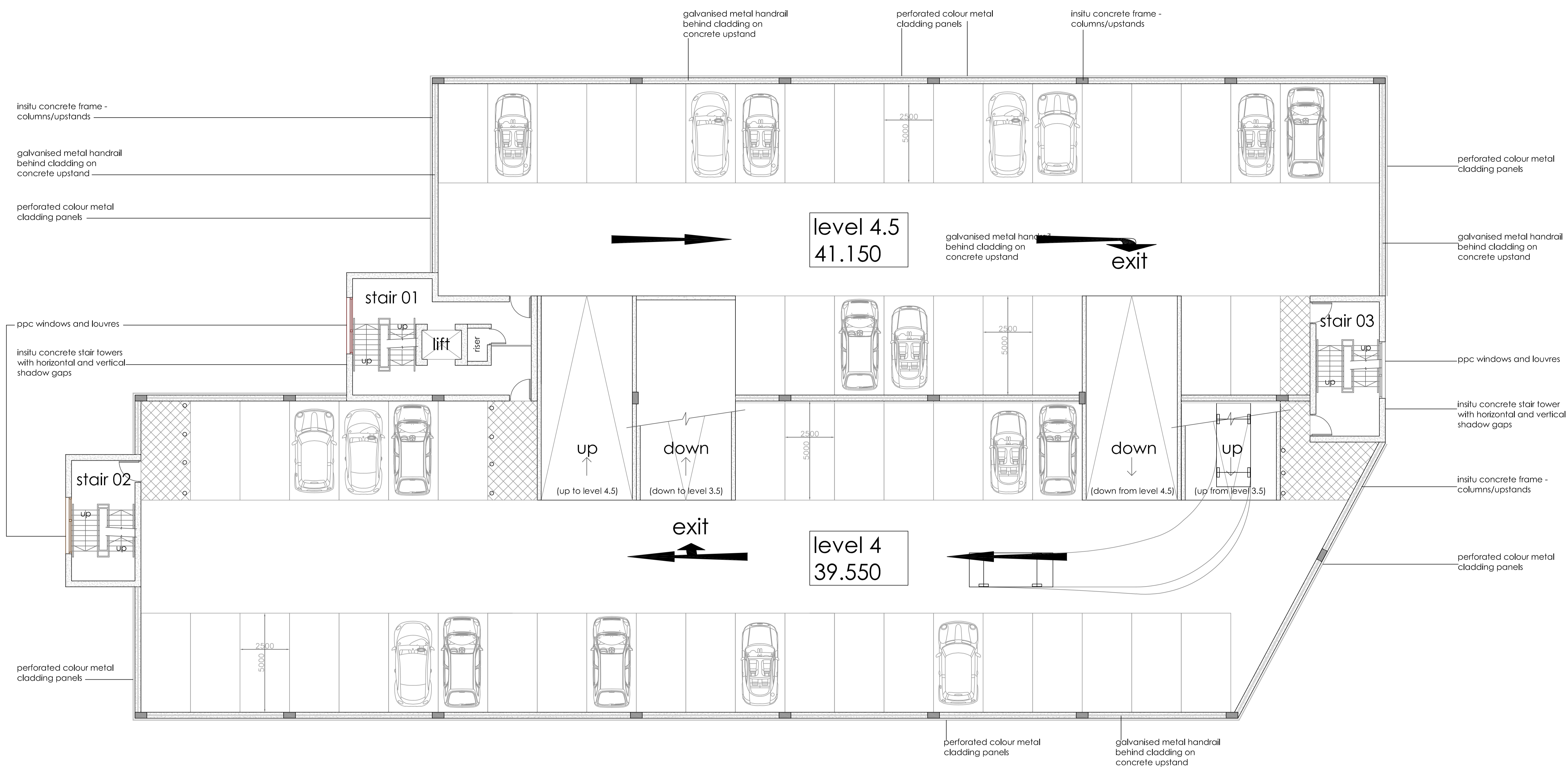

proposed floor plans showing levels 4 and 4.5 - scale 1 : 100
 (total 63 bays)

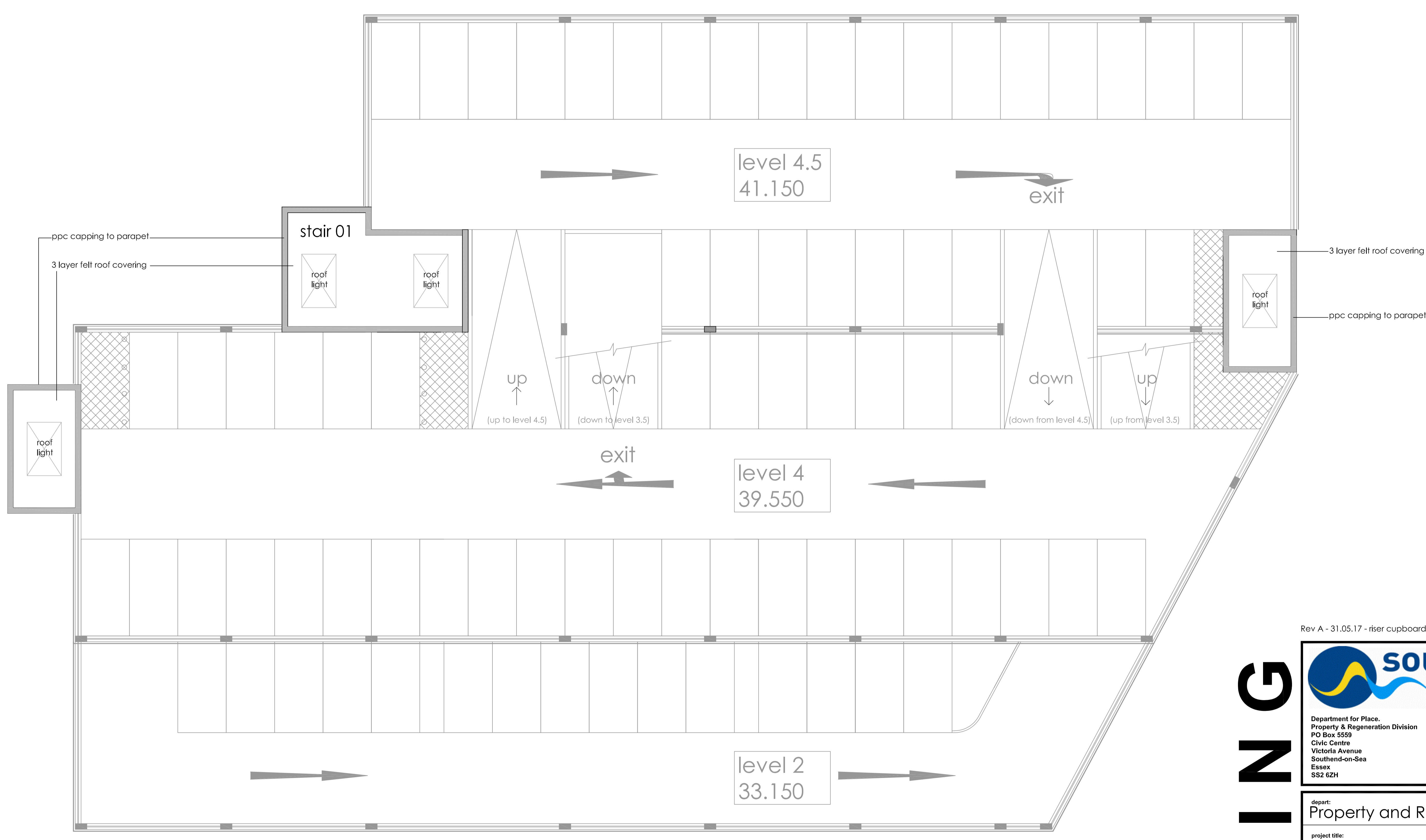

proposed roof plan - scale 1 : 100

Rev A - 31.05.17 - riser cupboard added.

southend on sea
 BOROUGH COUNCIL
 Department for Place,
 Property & Regeneration Division
 PO Box 5559
 Civic Centre
 Victoria Avenue
 Southend-on-Sea
 Essex
 SS2 6ZH

Report:
 Property and Regeneration
 project title:
new multi storey car park

site:
 new multi storey car park
 Victoria Avenue
 Southend-on-Sea

drawing title:
 proposed floor plans
 levels 4, 4.5 and roof plan

scale:
 @AO 1 : 100
 date: February 2017

drawing no:
1440/P/103
 sheet no: sheet 4 of 7
 revision: **A**

PLANNING